

2001 Series

0 - 400 PSIG



CRYOGENIC BAR STOCK BODY BELLOW SEAL VALVES MANUAL OR AUTOMATIC

Features

- Simple Conversion – The AutoSeal Actuator, for automatic operation, and the Unique Hand Wheel, for manual operation, are Easily Interchangeable
- Electro-polished Internals with All Orbital Butt Welded Design: Body, Bonnet, Flange and Nipples
- Compact Design & Reliability for an Economical Price
- Vacuum Jacketed or Non-Jacketed Extended Bonnet
- Top Entry Flanged Bonnet with Redundant Seals
- Multi-Ply Bellows are Cryogenic Tested & Proven

Applications

- Semiconductor & Electronic Grade High Purity Gas Lines
- Chemical, Pharmaceutical and Aerospace Ground Support
- Vacuum Jacketed and Insulated Piping System
- Cryogenic Storage Tanks and Transports
- Wherever Leak Tight Valves, Compact Design, Quality and Performance are Required

Options

- Flow Tips and Instrumentation Accessories for Actuator



UNIQUE DESIGN offers quick and easy change for Manual or Automatic operation without voiding the system's integrity or replacing operating parts. Innovation for the 21st Century.

Technical Data

Operating Ranges

Temperatures-456°F to +300°F
-271.1°C to +148.9°C

Operating Pressures up to 400 PSIG

Materials of Construction

All Major Structural and Internal Components are 300 Series Stainless Steel

SeatKel-F

GasketTeflon® and Viton®

Seals.....Viton®

Actuator:Pressed Steel Casing & Ductile Iron Yoke

Tests

External LeakageMass spec. to
1x10⁻⁹scc GHe/sec

Seat LeakageBubble Tight 150 PSIG
in Liquid Nitrogen with
GHe

Proof Pressure440 PSIG

Valve Sizes

1/2" ODT Standard

3/4" ODT available on request

How To Order

2001 - 04 - U E GT M - VJ

BASIC MODEL NUMBER _____

2001 Series Bellow Seal

VALVE SIZE _____

04 - 1/2"

CLEANING _____

- U - UHP Cleaned
- O - Oxygen (per 216-2 specification)
- C - Standard

INTERNAL FINISH _____

- E - Electro-Polished, UHP Cleaned
- S - Mill Finish

BODY CONFIGURATION _____

GT - Globe Pattern, Tube

SPECIAL ADD ON*

- CB - Cold Box Cuff
- VJ - Vacuum Jacketed
- Blank - Non-Vacuum Jacketed
- TW - Complete Top Works Kit with Stem
- SG - Soft Goods Kit: Packing, Gasket, Seat

TOP WORKS

- M - Manual Valve
- A - Automatic Valve without Actuator
- B - Automatic Valve with AutoSeal
- E - Automatic Valve with AutoSeal and Control Tip - EQ%
- L - Automatic Valve with AutoSeal and Control Tip - Linear

* Standard configuration is non-jacketed.

Dimensions & Specifications

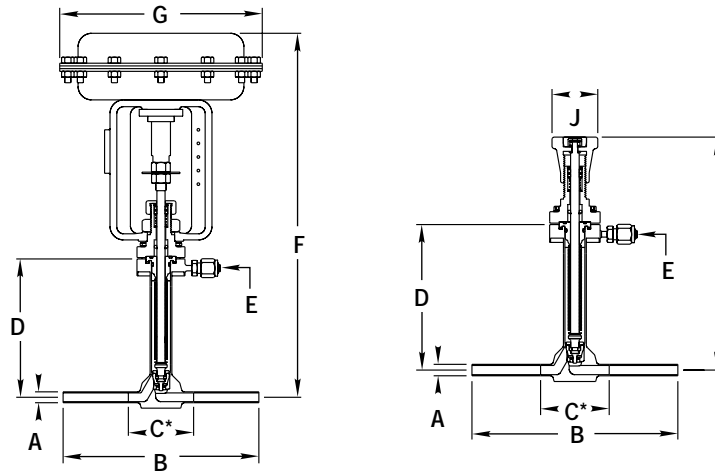

AUTOMATIC

Size	A	B	C*	D	E**	F	J	C _V
1/2"	1/2" ODT	9.0	3.0	6.36	1/4 VCR	16.75	9.31	2.5

MANUAL

Size	A	B	C*	D	E**	F	J	C _V
1/2"	1/2" ODT	9.0	3.0	6.36	1/4 VCR	10.44	2.0	2.5

*Available without nipples upon request.

**Available with 1/2" VCR end connections.

For actuator accessories and instrumentation, see AutoSeal Actuator.

Additional sizes available, please consult your Distributor, Representative or our factory for information.