

500 Series

.5-150 PSI

FLOW AT CRACKING PRESSURE

Elastomeric seals 5cc/min
 Teflon® .02 scfm

CRACKING PRESSURE TOLERANCE ± 5 %

Cracking pressure on initial crack may be higher than cracking pressure tolerance due to inherent characteristics of seals.
 (Consult factory)

LEAKAGE Ascending Pressure

Standard seals 0 to 95% of C.P.
 Silicon (524) & EPR (562) 0 to 80% of C.P.
 Teflon® (520)*

Cracking pressures up to 2.4 PSI – 4cc/min at 0 to 50% of cracking pressure

Cracking pressures 2.5 PSI and higher – 1cc/min at 0 to reseal pressure, 10cc/min from reseal to 90% of cracking pressures.

LEAKAGE at Reseal Pressure

All Elastomeric seals - Zero
 Teflon® - 1cc/min for cracking pressures 2.5 PSI & higher

0 to 10 PSI

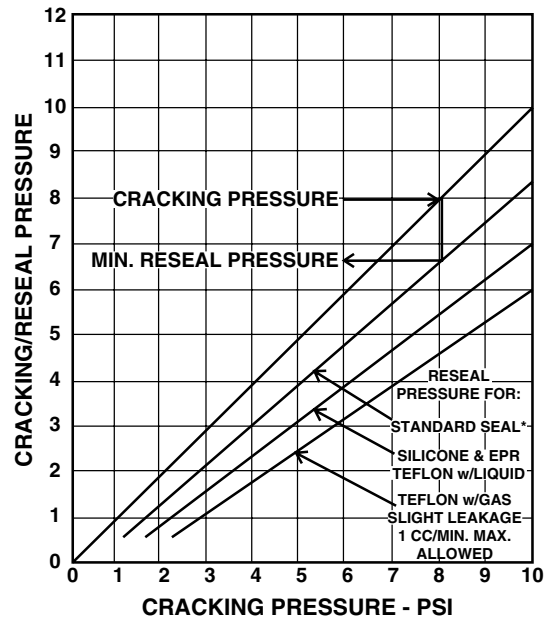

10 to 50 PSI

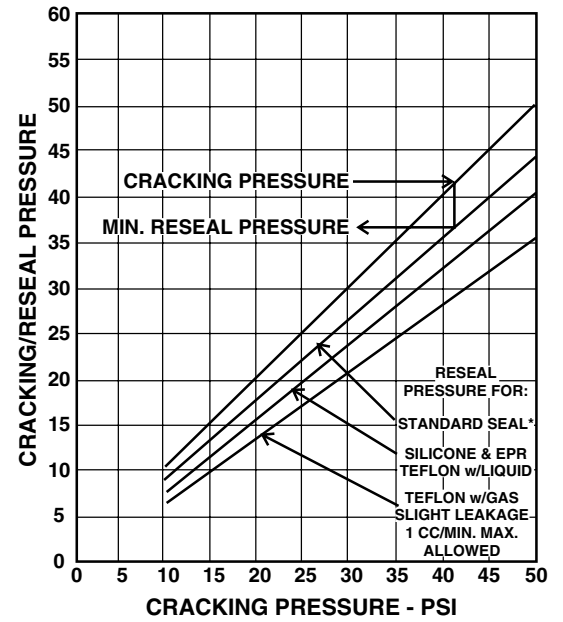

50 to 140 PSI

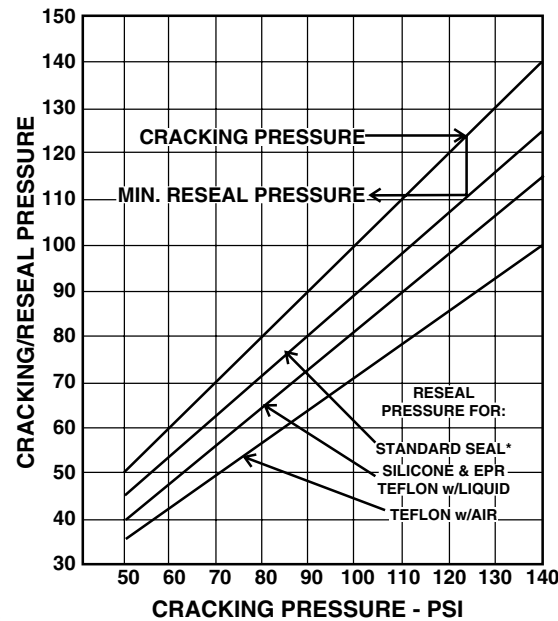

* STANDARD SEALS:
 Buna N (559)
 Viton® (532)
 Neoprene (533)

500 Series .5-150 PSI

Hydraulic Flow Curves (500-M) Popoff Relief Valves

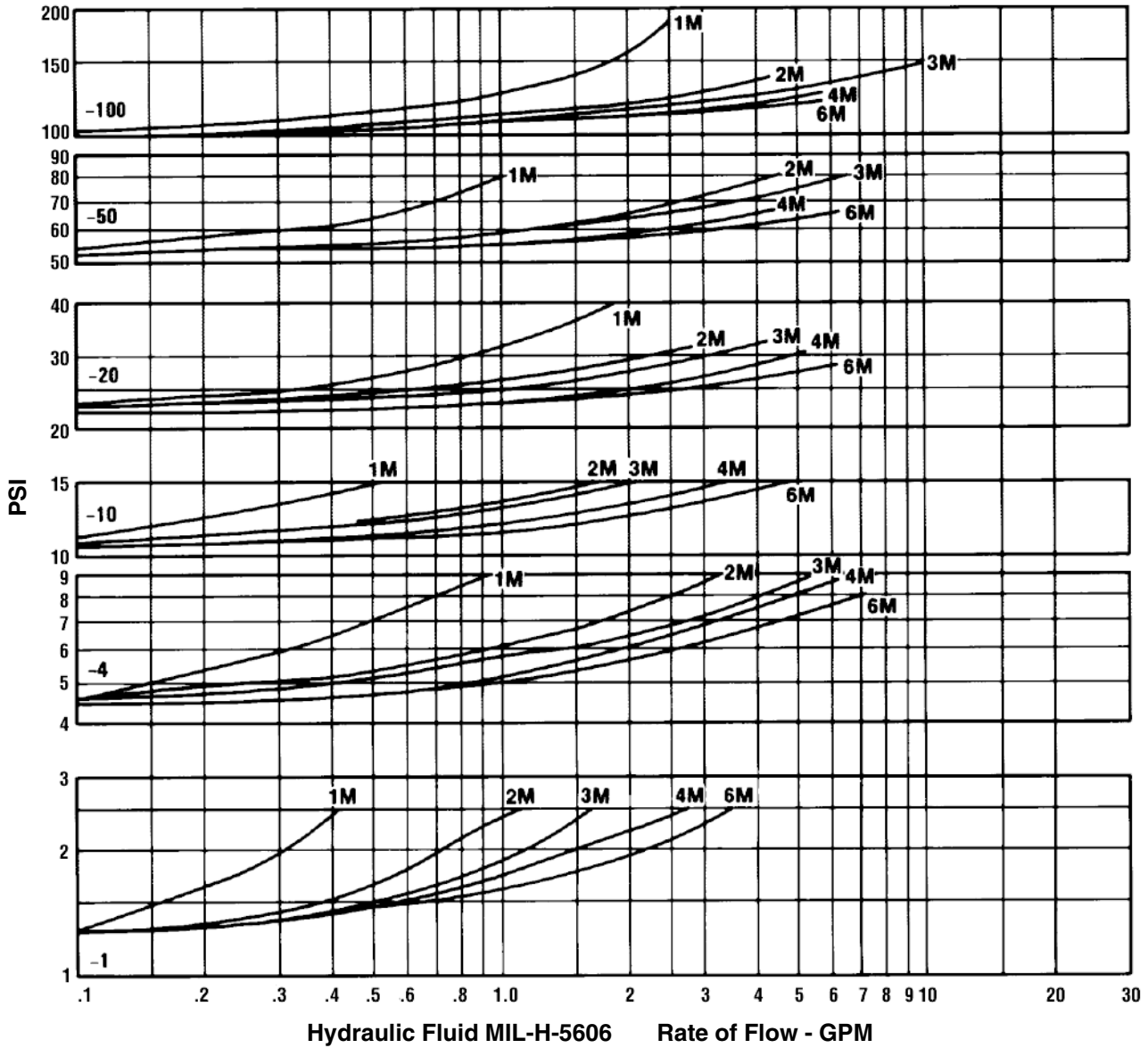

500 Series

.5-150 PSI

Hydraulic Flow Curves (500-MP) Inline Relief Valves

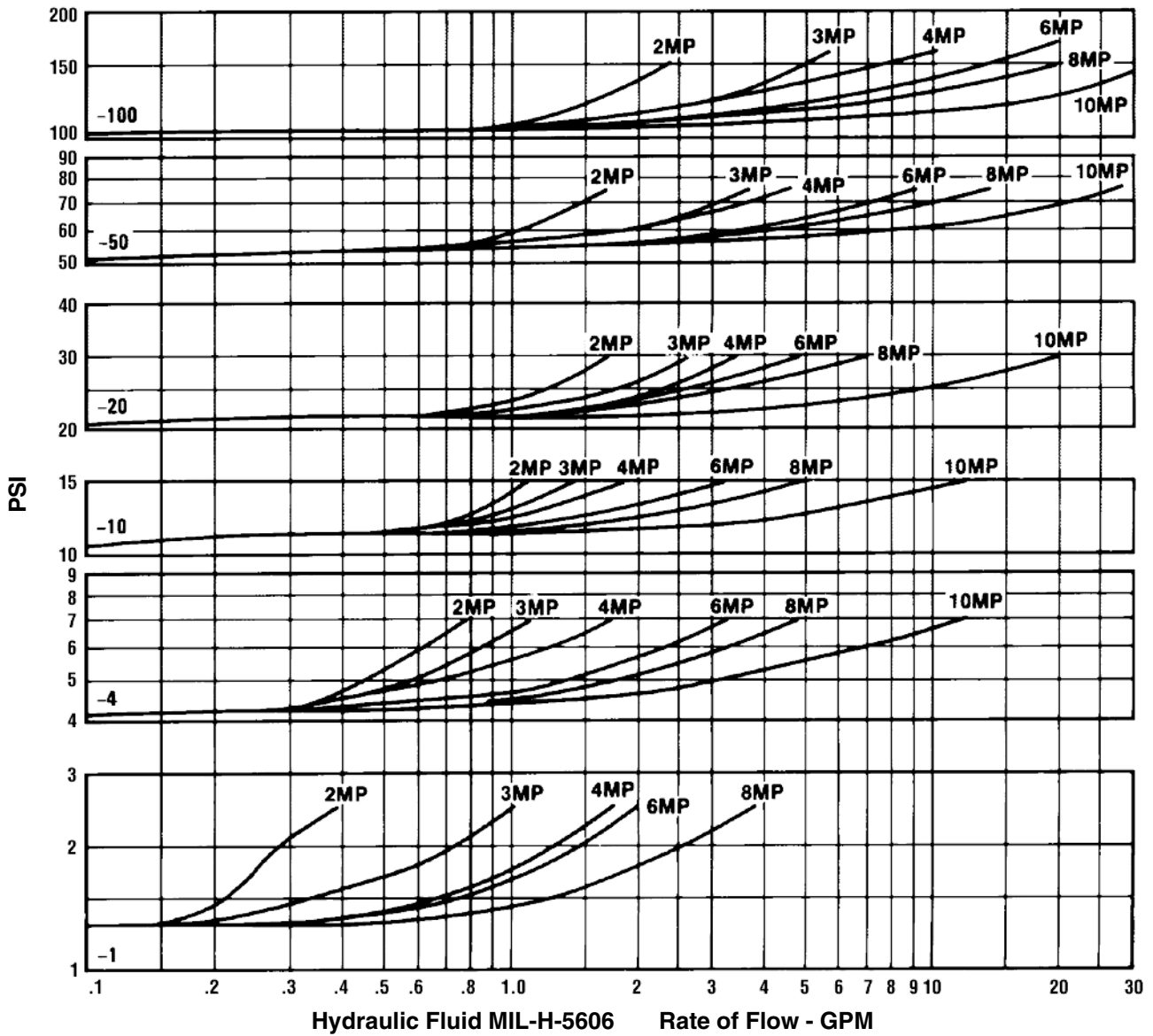

500 Series

.5–150 PSI

Air Flow Rates (500-M & -MP)

M—Popoff valves 1/8"–3/8"

MP—Inline valves 1/4"–1/2"

Crack Pressure PSIG	Percent Over Pressure Beyond Cracking (SCFM air at room temperature)								
	10%			25%			50%		
	1M/2MP	2M/3MP	3M/4MP	1M/2MP	2M/3MP	3M/4MP	1M/2MP	2M/3MP	3M/4MP
0.5	.08	.08	.80	.12	.17	.45	.14	.60	1.1
1	.10	.10	.10	.17	.35	.65	.20	.80	1.6
1.5	.12	.12	.15	.25	.46	.90	.40	1.0	2.0
2	.15	.14	.20	.34	.62	1.2	.63	1.4	2.5
2.5	.17	.17	.30	.42	.75	1.5	.80	1.8	3.1
3	.20	.21	.40	.50	.85	1.7	1.1	2.2	3.6
4	.23	.24	.50	.70	1.05	2.0	1.5	3.0	5.4
5	.28	.30	.50	.86	1.3	2.2	1.7	3.7	6.0
10	.60	.70	.60	1.65	3.2	3.8	3.2	7.0	11
15	.80	1.2	1.6	2.3	4.2	8.5	4.2	8.5	20
20	1.1	1.5	2.5	2.9	5.0	11.5	5.2	10	28
25	1.2	2.0	3.0	3.4	7.9	15	6.0	14	33
30	1.6	2.4	4.0	4.0	10.1	19.5	7.0	18	36
40	1.9	3.5	7.0	5.1	13	24.5	8.8	26	53
50	2.3	4.4	9.0	6.0	15	29	10.6	32	60
60	2.5	5.4	9.8	6.7	18	33	11.6	39	69
70	2.9	6.6	10.9	7.5	22.5	38	12.7	47	79
80	3.2	7.6	12	8.2	26	43	13.8	56	91
90	3.6	8.7	13.5	9.0	30.5	47	14.9	66	101
100	4.0	9.5	15	9.8	34	52	15.8	75	108
110	4.4	11.3	17.5	10.2	38	53.5	17.0	77.5	114
120	4.8	13.2	20.8	10.6	42.5	56.5	18.3	80	122
130	5.2	14.9	24	11	47	58.5	19.6	83	131
140	5.6	16.5	27.5	11.5	51	61.5	20.9	87	138
150	6.0	18	30	12	56	63	22.0	90	145

500 Series

.5–150 PSI

Air Flow Rates (500-M & -MP)

M—Popoff valves 1/2"–1"

MP—Inline valves 3/8"–1-1/4"

Crack Pressure PSIG	Percent Over Pressure Beyond Cracking (SCFM air at room temperature)								
	10%			25%			50%		
	4W6MP	6W8MP	8W10MP	4W6MP	6W8MP	8W10MP	4W6MP	6W8MP	8W10MP
.5	.07	.07	—	.50	.50	—	.80	2.2	—
1	.10	.10	—	.70	.70	—	1.7	3.2	—
1.5	.30	.30	—	1.0	1.4	—	2.2	5.5	—
2	.50	.50	—	1.2	1.7	—	3.0	7.0	—
2.5	.60	.60	—	1.8	3.0	—	4.2	10.5	—
3	.80	.80	—	2.2	4.0	—	5.0	13	—
4	1.0	1.0	1.5	3.0	5.0	30	7.5	17	56
5	1.0	1.2	2.5	3.5	6.0	34	9.0	20	64
10	1.0	2.4	7.0	6.0	12	60	19	40	115
15	1.6	3.0	7.0	8.5	22	60	27	80	160
20	2.0	5.0	7.0	10	30	60	34	110	190
25	3.0	5.5	9.0	13.5	34	72	43	116	—
30	3.5	6.0	11.5	16	37	80	50	121	—
40	5.5	8.5	18	24	48	115	72	136	—
50	7.0	10	23	30	56	140	90	150	—
60	11	13	35	38	64	160	100	165	—
70	15	17	59	47	72	185	111	182	—
80	20	21	77	56	81	215	123	204	—
90	26	26	88	68	94	235	138	225	—
100	30	30	100	75	105	250	150	240	—
110	33	38	115	80	112	258	166	—	—
120	37	47	132	86	125	270	183	—	—
130	41	57	150	93	150	282	201	—	—
140	46	71	175	102	163	290	222	—	—
150	50	80	190	110	175	300	240	—	—

500 Series

.5–150 PSI

Air Flow Rates (D500-M)

Popoff valves with deflector cap 1/8"–3/8"

Crack Pressure PSIG	Percent Over Pressure Beyond Cracking (SCFM air at room temperature)								
	10%			25%			50%		
	1M	2M	3M	1M	2M	3M	1M	2M	3M
.5	.12	.20	.15	.24	.50	.50	.44	1.2	1.1
1	.21	.30	.30	.40	.85	.85	.73	2.0	1.9
1.5	.21	.30	.30	.42	1.0	1.0	.80	2.7	3.1
2	.21	.30	.30	.45	1.2	1.2	.95	3.5	5.0
2.5	.22	.30	.30	.49	1.3	1.3	1.1	4.3	6.2
3	.23	.30	.30	.52	1.6	1.6	1.25	5.4	8.0
4	.23	.30	.30	.58	2.1	2.1	1.5	7.5	12
5	.32	.30	.30	.60	2.2	4.5	1.7	8.3	14
10	.70	.34	.40	1.6	2.5	14	3.2	12.6	23
15	1.4	1.3	1.5	2.0	6.0	18	3.9	16.5	29
20	1.8	2.2	3.0	2.7	10	23	5.4	21	36
25	1.9	3.0	8.0	2.8	11.5	27	6.0	23	40
30	2.0	4.0	14	3.0	14	32	7.0	27	47
40	2.3	5.9	26	3.5	18	42	9.0	33	59
50	2.4	8.0	39	3.8	25	54	10.5	40	74
60	3.2	17	43	4.6	33	62	11.4	46	—
70	4.0	26	47	5.5	41	70	12.4	52	—
80	4.9	36	52	6.4	50	79	13.7	59	—
90	5.9	46	58	7.5	61	89	15	67	—
100	7.0	56	65	8.5	72	100	16	76	—
110	7.3	56	65	9.5	73	113	24	80	—
120	7.7	57	66	12.8	74	127	33	84	—
130	8.1	58	67	16.2	76	142	43	89	—
140	8.6	59	68	20	78	158	53	96	—
150	9.0	61	70	25	80	176	60	104	—

500 Series

.5–150 PSI

Air Flow Rates (D500-M)

Popoff valves with deflector cap 1/2"–1"

Crack Pressure PSIG	Percent Over Pressure Beyond Cracking (SCFM air at room temperature)								
	10%			25%			50%		
	4M	6M	8M	4M	6M	8M	4M	6M	8M
.5	.15	.15	—	.30	.30	—	1.0	1.0	—
1	.30	.30	—	.50	.50	—	1.7	1.7	—
1.5	.40	.40	—	.60	1.5	—	3.2	7.5	—
2	.50	.60	—	.90	3.0	—	5.0	14.5	—
2.5	.60	.70	—	1.1	4.0	—	6.5	21	—
3	.70	1.0	—	1.4	5.5	—	9.0	29	—
4	1.0	1.5	—	3.0	9.0	—	13	45	—
5	1.0	1.8	—	4.0	13	—	15.5	49	—
10	1.5	4.0	92	10	36	115	28	75	145
15	9.0	26	127	22	66	—	42	101	—
20	18	50	170	36	100	—	58	131	—
25	21	60	173	43	112	—	65	—	—
30	25	74	177	51	128	—	74	—	—
40	33	100	188	67	158	—	91	—	—
50	42	130	200	85	195	—	110	—	—
60	49	148	225	95	220	—	—	—	—
70	56	167	251	106	247	—	—	—	—
80	64	188	278	117	275	—	—	—	—
90	73	212	308	130	305	—	—	—	—
100	85	240	340	145	340	—	—	—	—
110	89	246	355	152	347	—	—	—	—
120	93	253	372	159	355	—	—	—	—
130	98	261	390	167	363	—	—	—	—
140	103	270	415	176	375	—	—	—	—
150	110	280	440	185	390	—	—	—	—

500 Series

.5-150 PSI

Dimensions (Inches)

Valve Size & Codes

Size	Pipe Thread Male	Pipe Thread Male/Female	British Pipe Thread Male/Female	British Taper Pipe Male
1/8"	1M			1S
1/4"	2M	2MP	2SX	2S
3/8"	3M	3MP	3SX	3S
1/2"	4M	4MP	4SX	4S
3/4"	6M	6MP	6SX	6S
1"	8M	8MP		8S
1-1/4"		10MP		

Popoff

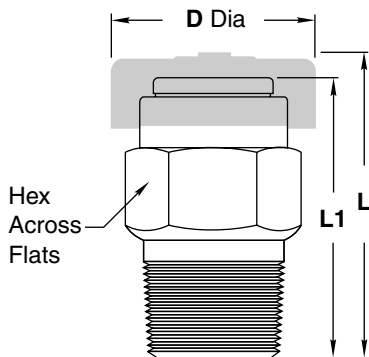

Popoff Valve Dimensions

Pipe Size Male	L	L1	Hex	D dia Max
1/8"	1.14	.98	1/2	0.63
1/4"	1.38	1.20	5/8	0.90
3/8"	1.43	1.25	3/4	1.21
1/2"	1.98	1.74	1	1.45
3/4"	2.31	2.07	1-1/8	1.45
1"	3.16	2.85	1-1/2	1.89

Inline

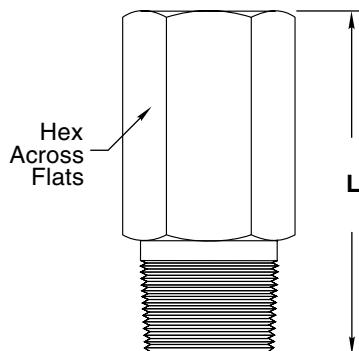

Inline Valve Dimensions

Pipe Size Male & Female	L	Hex
1/4"	1.62	3/4
3/8"	2.08	7/8
1/2"	2.34	1-1/8
3/4"	2.72	1-1/4
1"	3.62	1-1/2
1-1/4"	4.67	1-7/8

500 Series

.5–150 PSI

How to Order

D 5 59 A – 2 M – 10

VARIATION

- D - Deflector Cap
- K - Cryogenic Service, special cleaning & testing (Stainless Steel valves only)

BASIC MODEL NUMBER

500 Series

SEAL MATERIAL & TEMPERATURE RANGE

- | | |
|-------------------------|--------------------|
| 59 - Buna N | -40° F to +250° F |
| 62 - Ethylene Propylene | -65° F to +300° F |
| 33 - Neoprene | -40° F to +250° F |
| 24 - Silicone* | -65° F to +400° F |
| 32 - Viton® | -20° F to +400° F |
| 20 - Teflon® (520)** | -100° F to +400° F |
| 20 - Teflon® (K520)** | -320° F to +165° F |
| 80 - Teflon® (580) ** | -320° F to +165° F |

CRACKING PRESSURE

Specify cracking pressure setting in PSIG

CONNECTION

(See Valve Size & Type Codes table, page 9)

VALVE SIZE

Pipe sizes in 1/8" Increments
(See Valve Size & Type Codes table, page 9)

BODY MATERIAL

- A - Aluminum
- B - Brass
- T - 303 Stainless Steel
- T1 - 316 Stainless Steel

Notes:

D – Prefixed Part Number is supplied with a cap which diverts high pressure blasts from personnel and instruments, and serves as a rain and dust shield (NOT RECOMMENDED FOR CRACKING PRESSURES BELOW 2 PSI).

* Not available over 74.9 psi.

** 520 - Teflon® or o-ring

** K520 - Polished Teflon® o-ring, cryogenic testing and serialization

** 580 - Polished Teflon® o-ring

ASME valves are covered on a separate catalog sheet.

Teflon® and Viton® are registered trademarks of Dupont.

Please consult your Circle Seal Controls Distributor or our factory for information on special connections, operating pressures and temperature ranges.

Repair Kits

In normal service the only part(s) which may require replacement is(are) the seal(s). A repair kit may be ordered by placing a K/ in front of the complete part number, (i.e. K/559A-2M-10).

For Your Safety

It is the sole responsibility of the system designer and user to select products suitable for their specific application requirements and to ensure proper installation, operation and maintenance of these products. Material compatibility product ratings and application details should be considered in the selection. Improper selection or use of products described herein can cause personal injury or property damage.